

RoHS

| 版本 | 变更事项 | 依据 | 变更日期 |
|-----------|-------------------|------------|------|
| REV A0 | CHANGE CONTENT | THEREUNDER | DATE |

技术要求:
Technical requirement

一. 电气性能:

electrical performance

1-1. 额定电流: 1A AC DC.

rated current: 1A AC DC.

1-2. 接触电阻: $\leq 20m\Omega$

Contact resistance: $\leq 20m\Omega$

1-3. 绝缘电阻: $\geq 1000M\Omega$

Insulation resistance: $\geq 1000M\Omega$

1-4. 耐压: 550V AC/Minute

withstand voltage: 550V AC/Minute

二. 物理特性:

Physical characteristics

2-1. 环境温度: $-25^{\circ}C \sim 105^{\circ}C$

environmental temperature: $-25^{\circ}C \sim 105^{\circ}C$

2-2. 焊接温度: $+260^{\circ}C$, 10s max

welding temperature: $+260^{\circ}C$, 10s max

三. 材质:

Material

3-1. 塑胶: PA6T(Black) UL94V-0

plastic: PA6T(Black) UL94V-0

3-2. 插针: 磷铜/镀金

pin: Phosphor/Gold plated

| PIN | A | B | C |
|-------|-------|-------|-------|
| 2x2A | 2.94 | 1.27 | 4.42 |
| 2x3A | 4.21 | 2.54 | 5.69 |
| 2x4A | 5.48 | 3.81 | 6.96 |
| 2x5A | 6.75 | 5.08 | 8.23 |
| 2x6A | 8.02 | 6.35 | 9.50 |
| 2x7A | 9.29 | 7.62 | 10.77 |
| 2x8A | 10.56 | 8.89 | 12.04 |
| 2x9A | 11.83 | 10.16 | 13.31 |
| 2x10A | 13.10 | 11.43 | 14.58 |
| 2x11A | 14.37 | 12.70 | 15.85 |
| 2x12A | 15.64 | 13.97 | 17.12 |
| 2x13A | 16.91 | 15.24 | 18.39 |
| 2x14A | 18.18 | 16.51 | 19.66 |
| 2x15A | 19.45 | 17.78 | 20.93 |
| 2x16A | 20.72 | 19.05 | 22.20 |
| 2x17A | 21.99 | 20.32 | 23.47 |
| 2x18A | 23.26 | 21.59 | 24.74 |
| 2x19A | 24.53 | 22.86 | 26.01 |
| 2x20A | 25.80 | 24.13 | 27.28 |
| 2x21A | 27.07 | 25.40 | 28.55 |
| 2x22A | 28.34 | 26.67 | 29.82 |
| 2x23A | 29.61 | 27.94 | 31.09 |
| 2x24A | 30.88 | 29.21 | 32.36 |
| 2x25A | 32.15 | 30.48 | 33.63 |
| 2x26A | 33.42 | 31.75 | 34.90 |
| 2x27A | 34.69 | 33.02 | 36.17 |
| 2x28A | 35.96 | 34.29 | 37.44 |
| 2x29A | 37.23 | 35.56 | 38.71 |
| 2x30A | 38.50 | 36.83 | 39.98 |
| 2x31A | 39.77 | 38.10 | 41.25 |
| 2x32A | 41.04 | 39.37 | 42.52 |
| 2x33A | 42.31 | 40.64 | 43.79 |
| 2x34A | 43.58 | 41.91 | 45.06 |
| 2x35A | 44.85 | 43.18 | 46.33 |
| 2x36A | 46.12 | 44.45 | 47.60 |
| 2x37A | 47.39 | 45.72 | 48.87 |
| 2x38A | 48.66 | 46.99 | 50.14 |
| 2x39A | 49.93 | 48.26 | 51.41 |
| 2x40A | 51.20 | 49.53 | 52.68 |
| 2x41A | 52.47 | 50.80 | 53.95 |
| 2x42A | 53.74 | 52.07 | 55.22 |
| 2x43A | 55.01 | 53.34 | 56.49 |
| 2x44A | 56.28 | 54.61 | 57.76 |
| 2x45A | 57.55 | 55.88 | 59.03 |
| 2x46A | 58.82 | 57.15 | 60.30 |
| 2x47A | 60.09 | 58.42 | 61.57 |
| 2x48A | 61.36 | 59.69 | 62.84 |
| 2x49A | 62.63 | 60.96 | 64.11 |
| 2x50A | 63.90 | 62.23 | 65.38 |

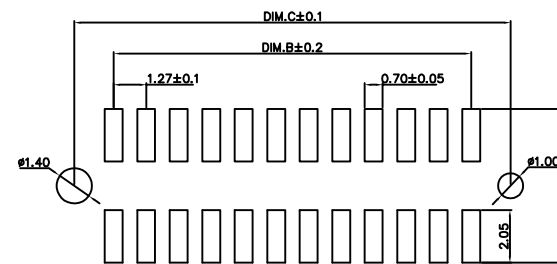
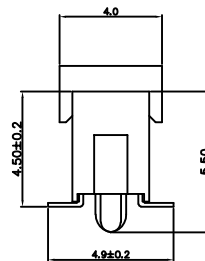
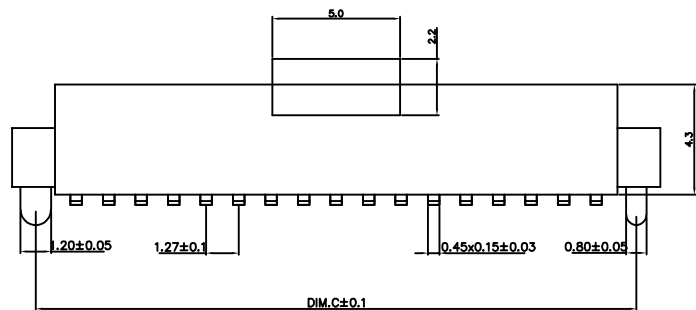
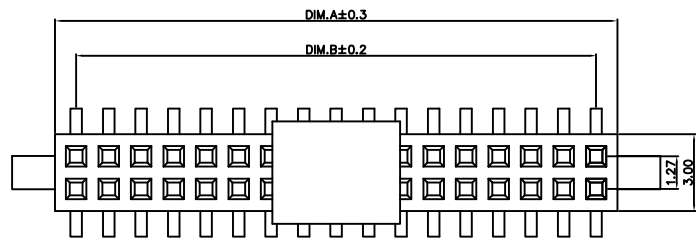

P.C.B LAYOUT

| 3 | 包装 | <input type="checkbox"/> 袋装 <input type="checkbox"/> 管装 <input checked="" type="checkbox"/> 卷装 <input type="checkbox"/> 盒装 | 1 | PCS |
|------|-----------|--|------|------|
| 2 | 塑胶 | PH1.27*4.3 2*nP PA6T料 带外柱 | 1 | PCS |
| 1 | 端子 | W4.9mm 磷铜镀金G/F | / | PCS |
| ITEM | PART NAME | DESCRIPTION | QUAY | UNIT |

| | | | | |
|----------|----|---------|---|--|
| | 单位 | mm | 泰华电子有限公司 TaiHua Electronics Co., Ltd | |
| | 比例 | | | |
| 核准: | | 版本: A0 | 产品名称: PH1.27mm 排母 G/F SMT 带外柱 | |
| 核检: | | 页次: 1/1 | 产品料号: | |
| 制图: 吕灿东 | | 日期: | 客户料号: | |
| DRAWN BY | | | Client No | |